

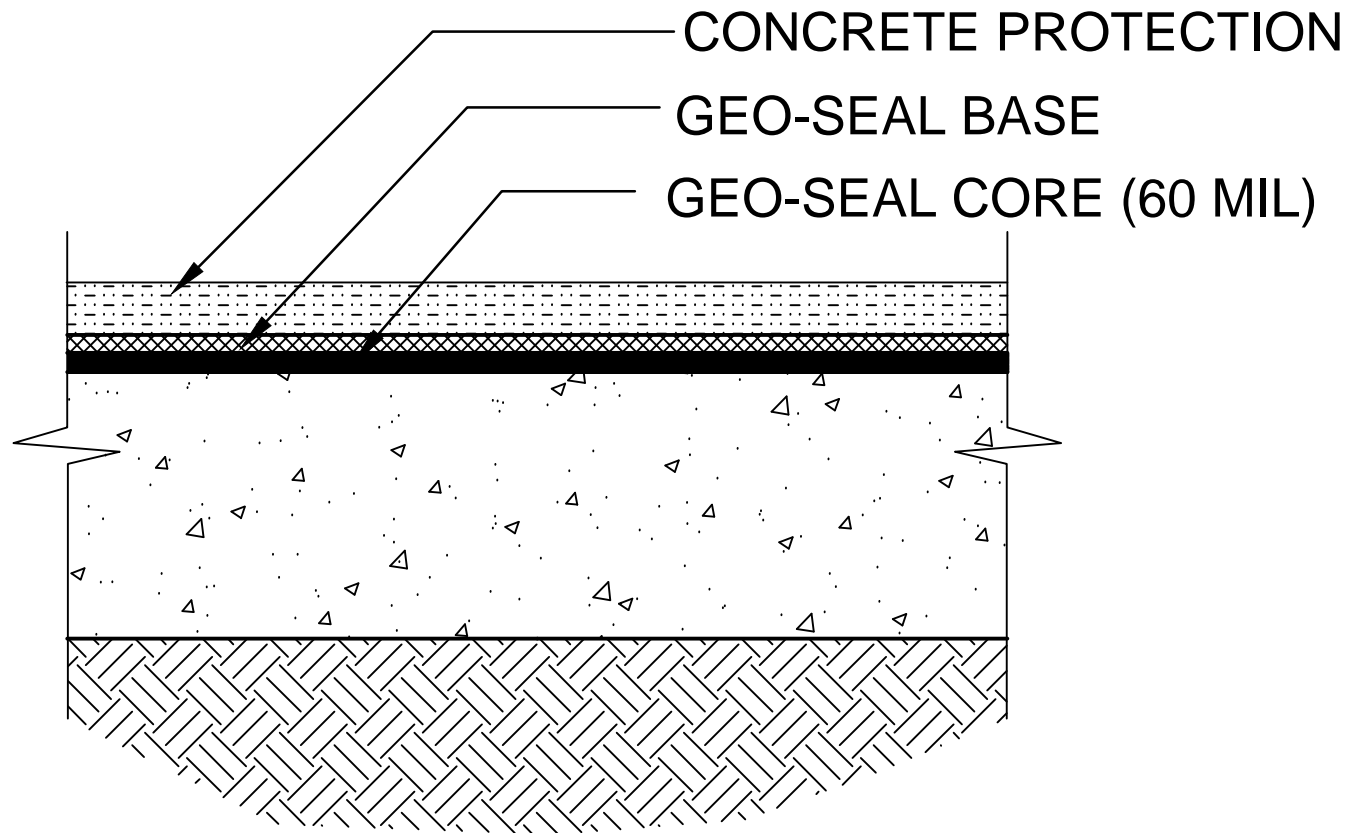

1011 CALLE SOMBRA
SAN CLEMENTE, CA 92673
949.481.8188 OFFICE
WWW.LANDSCIENTECH.COM
©2010 Land Science Technologies



Geo-Seal[®]
Vapor Intrusion Barrier

DATE

SCALE

TITLE

RETROFIT OVER
EXISTING SLAB
(OPTION 2)